



**Diamond Tools and Equipment**



**Product Catalog**

[icsdiamondtools.com](http://icsdiamondtools.com)

## FORCE4® & SealPRO Technology

Concrete cutting pros like you depend on your tools. All day, every day. Under the toughest conditions. You're the reason we invested four years developing the FORCE4® system, the strongest, longest-lasting diamond chain available. The precision and versatility you've come to expect from ICS in addition to the perfect blend of power and efficiency. The patented design better distributes the load, has 50% greater tensile strength than standard chains, and delivers the ideal combination of weight and strength to ensure a smooth cut and a long life. And the FORCE4 system with micro o-rings protecting every rivet joint, SealPRO keeps out the harsh abrasives in slurry that can cause chain stretch. SealPRO lessens water requirements and reduces chain tensioning.

A cutting revolution four years in the making Force4 diamond chain system with SealPRO technology is available for hydraulic, pneumatic, Petrol and now electric with the Pentruder High Frequency chain saw.

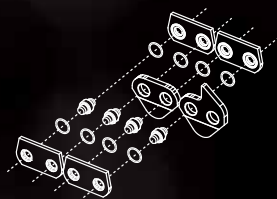



**ICS<sup>®</sup>**  
Diamond Tools and Equipment



# Table of Contents



## Concrete Cutting Solutions

ICS Petrol Power Saws .....	6-7
ICS Hydraulic Power Saws.....	8-9
ICS Pneumatic Power Saw .....	9

## Pipe Cutting Solutions

The PowerGRIT® Advantage .....	10
ICS PowerGRIT® Petrol Saws & Chain.....	11-12
ICS PowerGRIT® Hydraulic Saws & Chain.....	13

## ICS Diamond Tools & Accessories

ICS Diamond Chains.....	14-15
Accessories.....	16-17

## FAQ's, Information & Part Numbers

Information.....	18
FAQ's.....	19

ICS | Blount Europe S.A • Rue Emile Francqui 5 • 1435 Mont-Saint-Guibert • Belgium  
Tel +32 10 301 251 • Fax +32 10 301 259

Copyright 2016 ICS|Blount Inc. Pricing and specifications subject to change without notice. All rights reserved. ICS, EuroMAX, FORCE4, PowerGRIT®, WallWalker, SpeedHook and SealPro are registered trademarks of ICS. The best way to cut concrete, DCT, TSS, TwinPRO, and FORCE4® are trademarks of ICS. 1116



## Precision. Power. Performance. Safety.

ICS® is on a mission to help you get the job done faster and easier than you ever thought possible. For more than 25 years, our innovations in diamond tools and equipment have revolutionized concrete cutting - changing the way you work.

Patented ICS diamond chains, and saws, satisfy a full-range of infrastructure and construction applications. Your job demands power and precision. ICS provides tough, professional-quality tools that help you do it right. Deep plunge cuts, tight radiuses, clean square corners, concrete pipe taps and more; you're only limited by your idea of what's possible. And with end-to-end service from committed experts, you get the peace of mind to focus on what you do best.

Headquartered in Portland, Oregon, ICS also has a sales and distribution office in Belgium and a worldwide sales and service network covering more than 70 countries. ICS concrete chain saws, diamond chains, and related products are sold and supported by a network of ICS Authorized Dealers and backed by a comprehensive network of factory-trained personnel and service centers.



**Diamond Tools and Equipment**



# ICS Petrol Powered Saws

**NEW**



ALSO WORKS WITH  
PowerGRIT® UTILITY SAW CHAIN  
SEE PAGE 12

## Features & Benefits 695XL-F4

- Lower engine temperature with new piston & cylinder
- Longer life muffler with reinforced internal baffle
- Easy to start with higher energy ignition system
- New easy-to-tune carburetor

PART NUMBER	DESCRIPTION
575826	ICS 695XL F4 Powerhead
576151	ICS 695XL F4-12 Petrol Saw Package, with 30cm Guidebar & FORCE4-25 Chain
575872	ICS 695XL F4-16 Petrol Saw Package, with 40cm Guidebar & FORCE4-29 Chain

**NEW**



ALSO WORKS WITH  
PowerGRIT® UTILITY SAW CHAIN  
SEE PAGE 12

## 695XL-GC

PART NUMBER	DESCRIPTION
581192	ICS 695XL GC Powerhead
584296	ICS 695XL-14 GC Petrol Saw Package, with 35cm Guidebar & FORCE3™-32 Standard Chain
584300	ICS 695XL-16 GC Petrol Saw Package, with 40cm Guidebar & FORCE3™-35 Standard Chain

## 695XL

Most versatile Petrol powered saw for concrete and ductile iron

The new 695XL features include an easy to start engine with higher energy ignition system and durable, long-lasting components including a new muffler, carburetor and piston & cylinder. Available with 30 cm - 40cm guidebars and the entire line of MAX, FORCE4® and PowerGRIT® series diamond chains. Based on the best-selling 695 saw platform, the 695XL is the highest horsepower ICS Petrol saw for frequent-use by general construction, utility contractors and concrete professionals.

## TECHNICAL SPECIFICATIONS

Max Cutting Depth	40cm
Bar length	up to 40cm
Engine Speed	9300 +/- 150 rpm (max)
Idling Speed	2700 +/- 100 rpm
Horsepower	4.8 kW @ 9000 rpm
Engine Type	2-stroke, single cylinder, air cooled
Displacement	94 cc
Powerhead Dimensions	46 cm L x 36 cm H x 30 cm W
Guaranteed Sound Power Level, Lwa (1)	115 dB(A); (Kwa = 1.0 dB(A))
Sound Pressure Level, at Operator's Ear Lwa (1)	104.6 dB(A); (K = 1.0 dB(A))
Vibration, a hv, eq Concrete Cutting (2)	3.6 m/s² (K=0.2 m/s²) Front Handle 3.1 m/s² (K=0.2 m/s²) Rear Handle
Vibration, a hv, eq Pipe Cutting (2)	5.62 m/s² (K=0.2 m/s²) Front Handle 5.28 m/s² (K=0.2 m/s²) Rear Handle
Water Supply Requirement	Minimum: 1.4 bar
Water Flow Requirement	Minimum: 8 lpm
Fuel Mix Ratio	50:1 (2%) fuel-to-oil
Fuel Capacity	1 liter

(1) Measured in accordance with ANSI S12.51-2012/ISO3741:2010

(2) Measured in accordance with ISO5349-1:2001, ISO22867:2011 and ISO19432:2012



# Solutions for Concrete, Masonry and Stone

**NEW**

ALSO WORKS WITH  
PowerGRIT® UTILITY SAW CHAIN  
SEE PAGE 11



**680ES**

## Features & Benefits

- Easy to control choke, run and stop functions
- Prevent engine flooding with new multifunction lever
- Simple to start
- Expert tool at an affordable price

PART NUMBER	DESCRIPTION
576155	ICS 680ES GC Powerhead
584291	ICS 680ES-12 GC Petrol Saw Package, with 30cm Guidebar & FORCE3™-29 Standard Chain
584293	ICS 680ES-14 GC Petrol Saw Package, with 35cm Guidebar & FORCE3™-32 Standard Chain



## 680ES

Best value for cutting deep, square or irregular openings

Built to meet the operation and flexibility demands of the general construction user, the 680ES stands alone in terms of reliability and value. Easy to start with a new multifunction lever to control choke, run, and stop functions. The distinctive black powerhead houses specially designed carburetion and ignition systems that work together to ensure easy starting, cooler operation and dependable performance at just about any elevation. Available with 30 cm and 35 cm guidebars and the entire line of MAX series diamond chain. With a quick switch of the guidebar, chain and drive sprocket, the new 680ES can operate PowerGRIT® Utility Saw chain, designed to cut ductile iron pipe.

## TECHNICAL SPECIFICATIONS

Max Cutting Depth	35cm
Bar length	up to 35cm
Engine Speed	11500 +/- 500 rpm (max)
Idling Speed	2800-3200 rpm
Horsepower	3.7 kW
Engine Type	2-stroke, single cylinder, air cooled
Displacement	76.5 cc
Powerhead Dimensions	46 cm L x 29 cm H x 25 cm W
Guaranteed Sound Power Level, Lwa (1)	117 dB(A); (Kwa = 3.0 dB(A))
Sound Pressure Level, at Operator's Ear Lwa (1)	101.0 dB(A); (K = 2.0 dB(A))
Vibration, a hv, eq Concrete Cutting (2)	7.2 m/s <sup>2</sup> (K=1.0 m/s <sup>2</sup> ) Front Handle 8.5 m/s <sup>2</sup> (K=1.0 m/s <sup>2</sup> ) Rear Handle
Water Supply Requirement	Minimum: 1.4 bar
Water Flow Requirement	Minimum: 8 lpm
Fuel Mix Ratio	50:1 (2%) fuel-to-oil
Fuel Capacity	0.88 liter

(1) Measured in accordance with ANSI S12.51-2012/ISO3741:2010

(2) Measured in accordance with ISO5349-1:2001 and ISO22867:2011



# ICS Hydraulic Powered Saws



## 890F4

### Features & Benefits

- Most professional
- Optimum chain performance
- Easy starting
- Submersible

PART NUMBER	DESCRIPTION
566357	ICS 890F4 Powerhead, 30 l/m, with carry case, 30cm hose
566356	ICS 890F4 Powerhead, 30 l/m, with carry case, 2.5m hose
566353	ICS 890F4 Powerhead, 45 l/m, with carry case, 30cm hose
566354	ICS 890F4 Powerhead, 45 l/m, with carry case, 2.5m hose
566127	ICS 890F4-15 Saw Package 30 l/m with 38cm Guidebar, FORCE4®-29, carry case & 30cm hose

## 890 Series

Over 20 years of ICS® product innovation and The ICS 890 Series hydraulic cutting system offers the superior strength of FORCE4® technology. From the redesigned, more durable rear handle, to the easy to replace drive sprocket, this saw is engineered to stand up to your toughest jobs. In a package that exceeds industry standards this sleek powerhouse is packed with features designed to make it work as hard as you do.

### TECHNICAL SPECIFICATIONS

	30 LPM	45 LPM
Weight	12.4 kg with 38 cm bar and chain	
Bar Length	up to 63 cm	
Motor Speed	6100 rpm	6500 rpm
Powerhead Dimensions	58.5 cm L x 26.5 cm H x 24 cm W	
Torque	13.8 Nm	19.2 Nm
Horsepower	8.5 kW	13 kW
Hydraulic Supply	30 lpm, 172.5 bar	45 lpm, 172.5 bar
Noise Level	107 dB @ 1 m	
Water Supply	Minimum 1.5 bar	

\* product data shown is rated based on maximum input conditions and efficiency assumptions may vary dependent on power supply.



## 890F4-FL Flush Cut Saw

### Features & Benefits

- Cuts within 4,8 mm of a wall
- Optimum chain performance
- Most professional
- Easy starting
- Submersible

PART NUMBER	DESCRIPTION
566352	ICS 890F4-FLUSH Powerhead 30 l/m, 30 cm hose whips
566350	ICS 890F4-FLUSH Powerhead 30 l/m, 2.5 m hose whips





# ICS Hydraulic & Pneumatic Saws



814PRO

## Features & Benefits

- Lightweight
- Fits into small spaces
- Same power as the 890 Series saws

PART NUMBER	DESCRIPTION
75256	ICS 814PRO Powerhead 30 l/m
71675	ICS 814PRO Saw Package 30 l/m with 33cm Guidebar & TwinPRO-25 Diamond Chain

## 814PRO

It may be small but with as much power as the 890 series, the 814PRO is ready for the big jobs. Lighter than other hydraulic saws with the ability to cut perfectly square openings as small as 9 cm, the 814PRO is a natural for utility work and other applications where a mix of portability and power are required.

## TECHNICAL SPECIFICATIONS

Weight	6.8 kg with 32 cm bar and chain
Bar Length	33 cm
Motor Speed	8800 rpm
Powerhead Dimensions	36.3 cm L x 28.7 cm H x 23.4 cm W
Torque	9.5 Nm
Horsepower	8.5 kW
Hydraulic Supply	30 lpm, 172.5 bar
Noise Level	88 dB @ 1 m
Water Supply	Minimum 1.5 bar

\* product data shown is rated based on maximum input conditions and efficiency assumptions may vary dependent on power supply.

## ICS Pneumatic Saw



701-A

## Features & Benefits

- Durable die cast aluminum frame
- No fumes in trench
- Cut concrete and ductile iron
- Offers safe alternative to cutting with a circular saw

PART NUMBER	DESCRIPTION
573511	ICS 701-A Powerhead
574173	ICS 701-A Pneumatic Saw Package with 38 cm Guidebar & FORCE4®-29 chain
574171	ICS 701-A Pneumatic Saw Package with 38 cm Guidebar & PowerGRIT®-29 chain

(1) Measured in accordance with ANSI S12.51-2012/ISO3741:2010

(2) Measured in accordance with ISO5349-1:2001 and ISO22867:2011

## 701-A

Built tough to stand up to everyday use in the harsh environment of concrete cutting. Cut with ease, speed and portability through Reinforced Concrete, Brick, Block, Concrete Pipe, Ductile Iron, Cast Iron, PVC and Natural Stone. The ICS powerful air saw is designed to cut through walls, floors and columns in a single pass.

## TECHNICAL SPECIFICATIONS

Weight (without bar and chain)	13.8 kg
Powerhead Dimensions	58.5 L cm x 26.5 H cm x 30.5 cm W
Air Motor Power	5 kW
Air Supply Requirements (maximum)	6 bar 3.5 m³/min
Motor lubrication	Resin and acid-free SAE 5 W to SAE 10 W oil
Water Pressure Requirements	Minimum: 1.4 bar
Water Flow Requirements	Minimum: 8 lpm
Operating Speed	5,700 rpm (average free running) 4,900 sfm (average free running chain)
Vibration ahv, eq Concrete Cutting <sup>(2)</sup>	Front handle: 5.09 m/s² (K=0.2 m/s²) Rear handle: 5.07 m/s² (K=0.2 m/s²)
Vibration ahv, eq PowerGRIT® Cutting <sup>(2)</sup>	Front handle: 4.58 m/s² (K=0.2 m/s²) Rear handle: 4.43 m/s² (K=0.2 m/s²)
Guaranteed Sound Power Level Lwa (1)	113 dB(A); (Kwa=0.5 dB(A))

# The ICS PowerGRIT® Advantage

## PowerGRIT® – Safer. Faster. Easier.

ICS® Utility saws have addressed operator safety with a revolutionary grinding technology which eliminates rotational kickback and offers improved operator positioning when cutting pipe. Utilized by water and wastewater departments worldwide, this patented platform, exclusively from ICS, is designed to cut a variety of materials from ductile iron to plastic pipe with far less excavation. The ability to cut up to 63cm pipe completely from one side radically reduces the difficulty of the job. Complete your next job safer, faster and easier with ICS Utility chain saws.

### Features & Benefits

- No rotational kickback
- Single-point access
- Operator control
- Safer operation
- No flying debris or dust

### Cutting Applications

- Ductile Iron Pipe
- Cast Iron Pipe
- PVC Pipe
- HDPE Pipe
- Insituform Pipe Lining
- Asbestos\* Cement Pipe

## ICS PowerGRIT® Method Versus Conventional Method

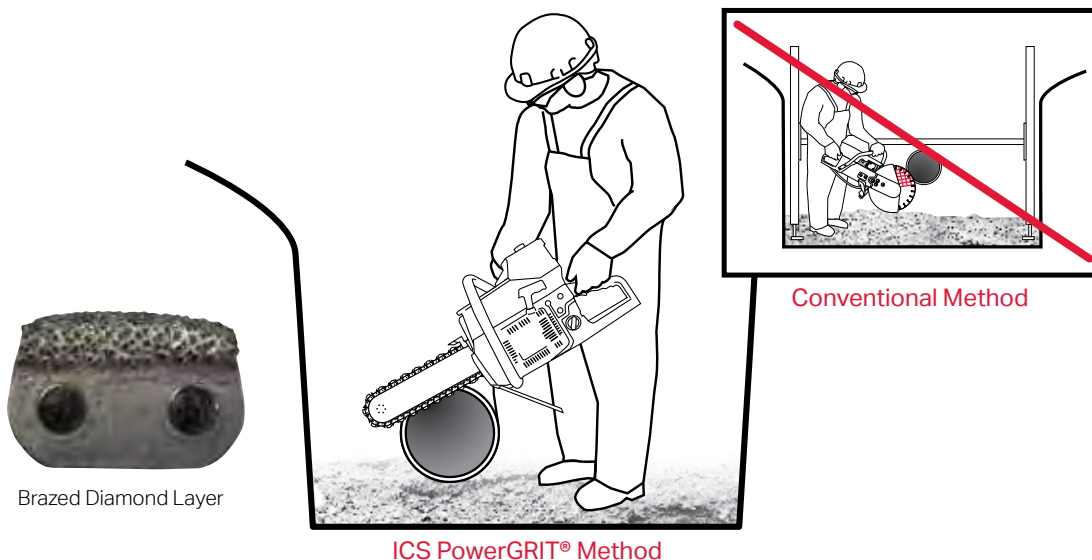

### ICS PowerGRIT® Method

- Cutting depth from 38 up to 63 cm
- No rotational kickback
- Gyroscopic motion eliminated
- Chain stops quickly after throttle is released
- Direct drive sprocket eliminates slippage
- Cutting depth allows for single side access
- Reduced excavation below the pipe, may eliminate the need for shoring

### Conventional Method

- Cutting depth of only 10 - 12 cm
- Operator exposed to potential rotational kickback
- Gyroscopic motion reduces saw control
- Blade continues turning after throttle is released
- Excess excavation needed to cut below the pipe
- Access to both sides of pipe is required
- Guard positioning compromises operator safety

Not all cities, municipalities, townships, and governments follow the same laws. Be sure to adhere to local guidelines and regulations when operating our products.

\* Asbestos is a hazardous material, known to cause serious respiratory diseases. Cutting into asbestos can release asbestos fibers into the air. Always research and follow the correct safety procedures, including applicable national and state or provisional occupational health and safety regulations, and protect yourself and those around you from asbestos-related disease. Always arrange for the material to be removed safely by a qualified person. ICS is not responsible for exposure to asbestos caused by use of this product.



# Solutions for Utility Pipe

**NEW**

ALSO CUTS CONCRETE, STONE,  
MASONRY & BRICK.

SEE PAGE 7



680ES-PG

## 680ES-PG

Built to provide a combination of performance and portability for cutting in-ground utility pipe, the 680ES-PG Petrol powered utility chain saw with PowerGRIT® chain will change the way you cut pipe. This affordably priced Petrol powered saw, allows you to cut up to 25cm deep from one side into ductile iron, cast iron, PVC, HDPE, Insituform lining and even Asbestos\*concrete pipe, and is also designed to run the full line of MAX series chains. With a quick switch of guidebar, chain and drive sprocket, you have the ability to use this saw in masonry, stone, and even reinforced concrete. Making it the most cost effective, versatile tool in your arsenal.

### Features & Benefits

- Lightweight powerhead
- Simple to start
- New multifunction lever
- Easy to control choke

### TECHNICAL SPECIFICATIONS

Max Cutting Depth	25cm
Bar length	25cm
Engine Speed	11500 +/- 500 rpm (max)
Idling Speed	2800-3200 rpm
Horsepower	3.7 kW
Engine Type	2-stroke, single cylinder, air cooled
Displacement	76.5 cc
Powerhead Dimensions	46 cm L x 29 cm H x 25 cm W
Guaranteed Sound Power Level, Lwa (1)	117 dB(A); (Kwa = 3.0 dB(A))
Sound Pressure Level, at Operator's Ear Lwa (1)	101.0 dB(A); (K = 2.0 dB(A))
Vibration, a hv, eq Concrete Cutting (2)	7.2 m/s² (K=1.0 m/s²) Front Handle 8.5 m/s² (K=1.0 m/s²) Rear Handle
Water Supply Requirement	Minimum: 1.4 bar
Water Flow Requirement	Minimum: 8 lpm
Fuel Mix Ratio	50:1 (2%) fuel-to-oil
Fuel Capacity	0.88 liter

(1) Measured in accordance with ANSI S12.51-2012/ISO3741:2010  
(2) Measured in accordance with ISO5349-1:2001 and ISO22867:2011



PART NUMBER	DESCRIPTION
576155	ICS 680ES Powerhead
580423	ICS 680ES PG-10 Petrol saw package with 25cm PowerGRIT® guidebar and PowerGRIT® chain

# The ICS PowerGRIT® Advantage

NEW

ALSO CUTS CONCRETE, STONE,  
BRICK & MASONRY  
SEE PAGE 6



695XL-PG

### Features & Benefits

- Longer chain life with Force4® Technology
- Ultimate versatility and power
- Also operates FORCE4® chain
- Highest horsepower for ductile iron

PART NUMBER	DESCRIPTION
575826	ICS 695XL PG Powerhead
575827	ICS 695XL PG-16 Petrol Saw Package with 40 cm FORCE4 Guidebar & PowerGRIT®-29 Chain

## 695XL-PG

### Petrol-Powered Utility Chain Saw

Built to provide the best combination of performance and portability for cutting in-ground utility pipe, the 695XL-PG Petrol-Powered Utility Chain Saw with PowerGRIT® chain will change the way you cut pipe. The 695XL-PG offers an unmatched power to weight ratio, allowing you to cut up to 40 cm deep from one side into ductile iron, cast iron, PVC, HDPE, and Insituform lining. Also the 695XL-PG is capable of operating the full line of 40 cm FORCE4® concrete cutting chains, meaning you can use the saw on masonry, stone, and even reinforced concrete - perfect for pipe taps, utility vaults, bridge work, and other utility applications.

### TECHNICAL SPECIFICATIONS

Max Cutting Depth	40cm
Bar length	up to 40cm
Engine Speed	9300 +/- 150 rpm (max)
Idling Speed	2700 +/- 100 rpm
Horsepower	6.4 hp (4.8 kW) @ 9000 rpm
Engine Type	2-stroke, single cylinder, air cooled
Displacement	94 cc
Powerhead Dimensions	46 cm L x 36 cm H x 30 cm W
Guaranteed Sound Power Level, Lwa (1)	115 dB(A); (Kwa = 1.0 dB(A))
Sound Pressure Level, at Operator's Ear Lwa (1)	104.6 dB(A); (K = 1.0 dB(A))
Vibration, a hv, eq Concrete Cutting (2)	3.6 m/s² (K=0.2 m/s²) Front Handle 3.1 m/s² (K=0.2 m/s²) Rear Handle
Vibration, a hv, eq Pipe Cutting (2)	5.62 m/s² (K=0.2 m/s²) Front Handle 5.28 m/s² (K=0.2 m/s²) Rear Handle
Water Supply Requirement	Minimum : 1.4 bar
Water Flow Requirement	Minimum: 8 lpm
Fuel Mix Ratio	50:1 (2%) fuel-to-oil
Fuel Capacity	1.0 liter





# Solutions for Utility Pipe



## Features & Benefits

- Also operates FORCE4® diamond chain
- Increased safety
- Better operator control
- Reduced excavation
- Versatility

PART NUMBER	DESCRIPTION
566537	ICS 890F4 Powerhead, 30 l/m, with carry case, 30 cm hose
566123	ICS 890PG-15 Saw Package 30 l/m, 38cm Guidebar, PowerGRIT®-29 chain, 30cm hose
566710	ICS 890PG-15 Saw Package 30 l/m, 50cm Guidebar, PowerGRIT®-34 chain, 2.5m hose, case

## 890PG

### Hydraulic-Powered Utility Chain Saw

If you're looking for the highest level of performance and cutting capability, look no further. The 890PG Hydraulic-Powered Utility Chain Saw offers cutting depths up to 63 cm in ductile iron, cast iron, PVC, HDPE, and Insituform lining. The deep cutting ability of the 890PG with PowerGRIT® utility chain, allows the operator to make a single cut from one side meaning less excavation is required. The 890PG is also capable of operating the full-line of 890F4 FORCE4® concrete cutting chains, meaning you can use the saw on masonry, stone, and even reinforced concrete - perfect for pipe taps, utility vaults, bridge work, and other utility applications.

## TECHNICAL SPECIFICATIONS

	30 LPM	45 LPM
Weight	12.4 kg with 38 cm bar and chain	
Bar Length	up to 63 cm	
Motor Speed	6100 rpm	6500 rpm
Powerhead Dimensions	58.5 cm L x 26.5 cm H x 24 cm W	
Torque	13.8 Nm	19.2 Nm
Horsepower	8.5 kW	13 kW
Hydraulic Supply	30 lpm, 172.5 bar	45 lpm, 172.5 bar
Noise Level	107 dB @ 1 m	
Water Supply	Minimum 1.5 bar	

\* product data shown is rated based on maximum input conditions and efficiency assumptions may vary dependent on power supply.



# ICS Diamond Chain

## Diamond Chain Technology

Diamond chains are not all created equal, so insist on Diamond Chains from ICS®, the people who invented the technology. As the inventors of Diamond Chain Technology™, ICS is committed to continually improving the quality and versatility as well as the perfect blend of power, precision and efficiency: chains specifically designed for different saw types as well as the many different materials you encounter on the job. Choosing the right chain for your needs is essential to getting the best value for your purchase.

### FORCE3™ Series Diamond Chain

- Segments designed for general use
- Laser welded to patented chain chassis
- Contains patented SealPRO® O-ring technology for longer life
- Segment types for general and specialty applications

### FORCE4® Series Diamond Chain

- Strongest, most durable, patented chain design
- Laser welded diamond segments
- Contains SealPRO O-ring technology for longer life
- Designed for heavy, professional use

### PowerGRIT® Utility Chain

- Single brazed diamond layer
- Patented cutter design
- Available for Petrol, hydraulic and pneumatic
- Utilizes FORCE4 chassis for maximum durability

### Chain Selection Chart

Chain Applications	Saw	Soft Stone/ Abrasive/Brick	Medium Concrete/ Light Reinforcement	Hard Concrete/ Heavy Reinforcement/ Hard Stone	Ductile Iron/Cast Iron/PVC/HDPE
FORCE3™ Standard General Purpose	680ES 695XL GC	♦	♦		
FORCE3™ Premium For harder materials	680ES 695XL GC		♦	♦	
FORCE3™ Brick Ideal for brick & block	680ES 695XL GC	♦			
FORCE4® General Purpose	890 Series 695XL F4		♦	♦	
FORCE4® Premium L Longer Cutting life	890 Series 695XL F4		♦	♦	
FORCE4® Premium S Faster cutting speed	890 Series 695XL F4		♦	♦	
FORCE4® Abrasive Ideal for brick & block	890 Series 695XL F4	♦			
PowerGRIT® For Utility Pipe	890 Series 695XL PG 680ES PG				♦



## Diamond Chain with SealPRO® Technology

Revolutionary SealPRO Diamond Chain from ICS is a true design breakthrough that reduces chain stretch by 50% or more, potentially giving you more life out of your diamond chain, even in the most abrasive applications and in situations where water is a premium. SealPro technology is based on a patented design with micro O-rings inserted around every rivet, on every link, sealing out abrasive materials that cause chain stretch.

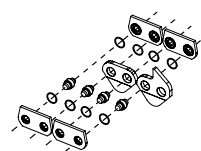



Introducing

## **FORCE3** DIAMOND CHAIN™

### Force3™ Series Diamond Chain



All Force3 Diamond Chains contain patented SealPRO® anti-stretch technology which reduces wear and extends chain life by sealing out the abrasive slurry that leads to chain stretch. Designed to be used with the full line of ICS petrol-powered saws, these chains offer the ultimate combination of both versatility and affordability. Available in three configurations to match your specific application and cutting challenges.

#### Force3™ Standard

Patented roof-top diamond segment improves break-in time. Works well in all materials including light rebar and is a fast-cutting, economical chain for everyday use.

#### Force3™ Premium

With the highest diamond concentration in the Force3 line, this chain is optimized for cutting harder materials, especially hard aggregate or heavily reinforced concrete.

#### Force3™ Brick

Optimized for abrasive materials, this chain has larger diamond segments for longer life. It is the best chain for cutting brick, block or abrasive stone.

### FORCE4® Diamond Chain



From the company that revolutionized concrete saws comes a revolution in diamond chains: FORCE4®. Designed to be the strongest, longest lasting diamond chains ever made, the FORCE4® series delivers unrivaled performance in professional cutting applications.

#### FORCE4®

Tough general purpose diamond chains that excel in common cutting jobs.

#### FORCE4® Premium L

Delivering longer life in hard aggregate, this is the best choice when faced with the more demanding jobs.

#### FORCE4® Premium S

Speed and strength in one chain. Built to cut fast in medium to hard concrete.

#### FORCE4® Abrasive

A heavy duty diamond chain that excels in the harshest, most abrasive cutting environments.



### PowerGRIT® Utility Diamond Chain



Utilized by public and private water and wastewater departments worldwide, this patented platform exclusively from ICS is designed to cut a variety of materials from ductile iron to plastic pipe. Featuring a brazed layer diamond coating on our FORCE4 platform, this chain makes your job safer, faster and easier.

# ICS Accessories



## Portable Hydraulic Powerpack

ICS® Petrol powered powerpacks are a dependable, self-contained source of hydraulic power that offer superior cooling capacity. The functional, ergonomic design makes them easily transportable to any job site.

### P95 18 hp (13.5 kW) Powerpack

Affordable hydraulic power with exceptional cooling capability in an easy to carry package. Adjustable for 20 lpm or 30 lpm operation.

PART NUMBER	DESCRIPTION
550888	P95 13.5 kW Powerpack



## 890F4/701-A Pipe Clamp

In addition to the time saving value of PowerGRIT® technology, the pipe clamp accessory developed for the underground pipe application brings a whole new level of safety, accuracy and ease of use to the job. With a simple adaptor, you can mount to this clamp and dramatically reduce the effort of handling the saw, while providing a solid, stable cutting platform that also improves operator safety and the precision of the cut.

FOR 890F4 / 701-A ONLY

PART NUMBER	DESCRIPTION
537640	Pipe Clamp
537634	Axle replacement

## Flow Adapter Valve

Enjoy the convenience and efficiency of powering your ICS® hydraulic saw from skid steers, backhoes, and other common construction equipment. Available for 30 lpm saws.

PART NUMBER	DESCRIPTION
70350	30 lpm Flow adapter valve

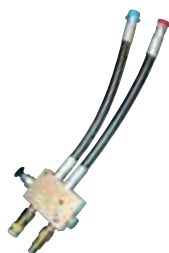

## Hydraulic Hoses

Quick disconnect, 7.5 m, two-way, with QD couplers

PART NUMBER	DESCRIPTION
70466	Hoses 7.5 m





## Portable Water Supply

When water isn't readily available, this corrosion resistant water supply system, with poly tank provides the solution. Able to hold up to 35 liters, this system offers the pressure and flow that ICS saws require. The High-Flo pump provides 4 litres per minute at 2.5 bar and comes with alligator clips for 12v battery hookup. Comes with a whip fitted with a standard hose end, ready for any regular hose.

PART NUMBER	DESCRIPTION
551529EU	Portable Water Supply



## SpeedHook®

SpeedHook® is an ingenious accessory designed to support the weight of ICS® hydraulic saws, dramatically reducing operator fatigue and extending chain life.

PART NUMBER	DESCRIPTION
528551	SpeedHook System includes 1m rail & mounting bracket



## ICS® 2-Stroke Oil

Intensive laboratory and field testing have resulted in an oil formula that is cleaner burning, provides better thermal protection and an improved film barrier reducing piston ring wear. Protect your investment with work-proven ICS® 2-stroke Engine Oil.

PART NUMBER	DESCRIPTION
571229	2% Mix, 100 ml Bottles (6-pack)
571230	2% Mix, 100 ml Bottles (24pack)



## Replacement Parts

Visit your local dealer or see our website [icsdiamondtools.com/customer-service-support/](http://icsdiamondtools.com/customer-service-support/) for a complete listing of available parts.

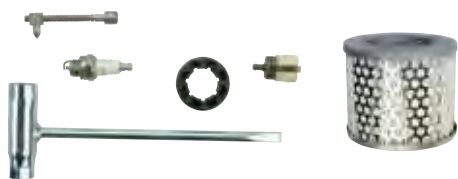

## ICS® Large Carry Case

Fits 880, 890 and 853PRO series.

**PART NUMBER 505049**



# Outperform your competition

This is not your first rodeo. Every day, along with the challenge of cutting through concrete, masonry, stone or utility pipe, you're managing your crew and your equipment to get the maximum return from every dollar.

ICS understands that time is money and that is why ICS and Pentruder tools are designed with your productivity in mind. Concrete cutting chainsaws that make it easier to tackle hard to reach spots. Diamond Chains with technology built in to prevent stretch and keep you in the cut instead of making adjustments. Wall saws constructed of machined billet aluminum for ultimate accuracy and durability. High frequency power for amazing productivity. ICS PowerGRIT®, the utility pipe cutting chain, grinds through iron pipe from one side even while wet or submerged when a belt driven cut off saw slips. Less effort, more productivity.

When you have high quality, powerful, reliable tools, you minimize the effort of your operators, complete jobs more quickly and move on to the next job. The result? Productivity. Operational efficiencies, happy employees and ultimately, more profit for your business.





# Frequently Asked Questions

## WHEN DO I NEED TO REPLACE A CHAIN?

When the diamond segment has worn down to the welded pad on the chain chassis. Typically a chain will cut 12-24 m in 15 cm concrete. On ICS hydraulic saw, this range is most often doubled.



Worn FORCE4® chain



Worn PowerGRIT® chain

## WHAT IS THE PROPER CHAIN TENSION?

All chains have a tendency to stretch when used. Diamond chains stretch more than wood cutting chains because of the abrasive materials they cut. If the chain is too tight, a lot of the saw's power goes into turning the chain rather than the cut. In extreme over-tightened cases, the saw may not be able to turn the chain at all. In addition, damage can occur to the bar nose and premature stretch may occur.

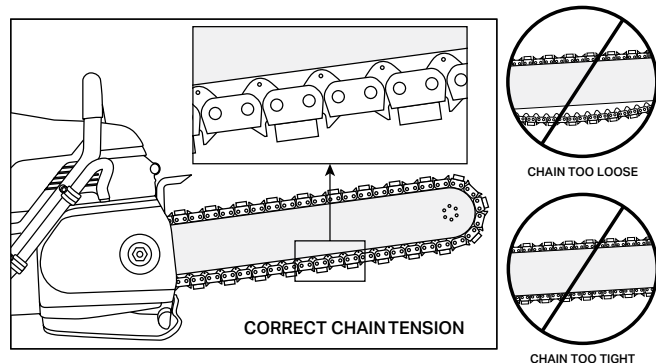

If the chain is too loose, it could come off the bar, or it will allow the drive sprocket to spin without turning the chain, which can chew up drive links. When a chain stretches to a point where the drive links are hanging approximately 12 mm to 18 mm below the bar, it is time to tension the chain.

See ICS training videos for saw setup

## REGARDING CUTTING PIPES THAT ARE FULL OF WATER... CAN I CUT INTO THE PIPE AND RELY ON THE WATER INSIDE TO COOL THE CHAINS (DIAMOND AND POWERGRIT®)?

The cooling and lubrication for the chains needs to be delivered thru the saw/guidebar and therefore you must have a minimum water pressure of 1.5 bar going through the saw.

## CAN I POUR WATER ON THE CHAIN IF I DO NOT HAVE A WATER SOURCE DELIVERABLE THROUGH A HOSE?

The guidebar is designed with water channels that distribute water to the chain to lubricate and cool and also flush the chain of debris. Pouring water on the chain is not only dangerous, it will drastically increase chain stretch and reduce chain and bar life

## YOU DID NOT SPECIFY THE AMOUNT OF WATER NEEDED TO CUT CONCRETE, BRICK, BLOCK OR EVEN DUCTILE IRON PIPE. IS THE WATER REQUIREMENT DIFFERENT FOR THESE?

The water requirement for using the ICS Diamond Chain or the ICS PowerGRIT® Chain to cut any of the above is the same however if you can use more water, especially when cutting abrasive things like brick and block, more water helps to add to longer chain and guidebar life because it is flushing the abrasive materials away.

## WHAT IF IT IS FREEZING OR BELOW FREEZING AND I CANNOT GET WATER TO MY SAW BECAUSE THE HOSE OR SAW IS FROZEN AND PLUGGED UP...CAN I MAKE MY CUT?

Water as previously stated is crucial to the performance of these chains. There are several different anti-freeze products you can use in this situation. Contact your regulatory agency for specific details.

## WHEN DO I NEED TO REPLACE MY DRIVE SPROCKET?

Drive sprockets need to be replaced when the groove has worn 50% of the way through the top of the sprocket tooth. A rule of thumb for ICS Petrol saws is every 2-4 chains and for ICS hydraulic saws, every 7-9 chains (depending on chain chassis).

HYDRAULIC



NEW → REPLACE

PETROL



NEW → REPLACE

## CAN A DIAMOND CHAIN CUT REBAR?

Yes, number 12 or 16 mm bar is not a problem. Anything over number 25mm is difficult. Large amounts of rebar will reduce chain life. Caution: rebar must be surrounded by concrete or aggregate material.

## WILL POWERGRIT® CUT STEEL?

PowerGRIT® utility chain is designed to cut ductile iron pipe, cast iron pipe, HDPE and PVC.

## WHAT IS THE MIXTURE RATIO OF FUEL TO OIL

Consult your operator manual for the proper fuel to oil mix recommendation.

## WHAT STEPS SHOULD I TAKE DAILY TO MAINTAIN MY SAW?

After each use, rinse the saw, bar and chain with water. Inspect all fasteners, sprocket, starter rope and air filter for wear. Oil the guidebar, diamond chain and bar nose sprocket and grease the chain tensioner.

## WHEN USING A NEW CHAIN THINK ABOUT OPENING UP THE DIAMONDS BY MAKING A FEW CUTS IN AN ABRASIVE MATERIAL.

For more information and to view instructional videos, please visit: [icsdiamondtools.com](http://icsdiamondtools.com).



**Diamond Tools and Equipment**



**[icsdiamondtools.com](http://icsdiamondtools.com)**



ICS | Blount Europe S.A  
Rue Emile Francqui 5 • 1435 Mont-Saint-Guibert • Belgium  
Tel +32 10 301 251 • Fax +32 10 301 259