



CONCRETE. STONE. MASONRY. PIPE.

POWERGRIT® UTILITY PRODUCTS



HYDRAULIC POWER



PETROL POWER

2013 PRODUCT GUIDE & MASTER PRICE LIST

SAFER. FASTER. EASIER.

The ICS Utility chain saw, equipped with PowerGrit® utility chain has addressed operator safety with its revolutionary grinding technology with the elimination of rotational kickback and improved operator positioning when cutting pipe. This patented platform, exclusively from ICS, is designed to cut a variety of materials from ductile iron to plastic pipe with far less excavation. The ability to cut all the way through from one side radically reduces the difficulty of the job. Complete your next job safer, faster and easier with ICS Utility chain saws.

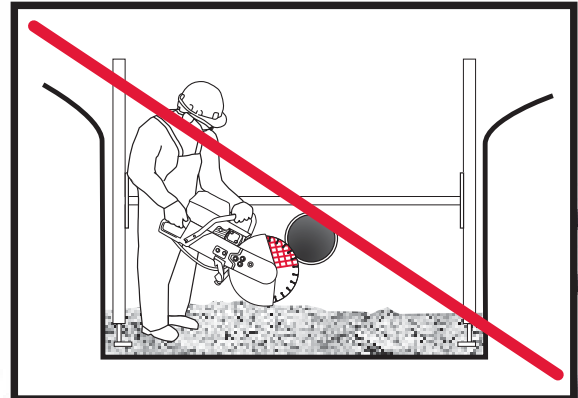

Scan here with your smart phone to view
our utility saw chain products in action.



Effective January 1, 2013

ICS | Blount Europe S.A. • Rue Emile Francqui, 5 • 1435 Mont Saint-Guibert, Belgium • T +32 10 301 251 • F +32 10 301 259

© 2013 ICS | Blount Inc. PowerGrit® is a registered trademark and patent pending product of Blount Inc. 0213

POWERGRIT.COM

POWERGRIT® UTILITY SAW CHAIN BENEFITS

BENEFITS	FEATURES
Increased Safety	<ul style="list-style-type: none"> • No rotational kickback toward operator • Unique diamond abrasive cutting design • Chain designed for smooth pipe cutting • Integrated wet cutting system • Designed for safety in utility applications
Improved Operator Control	<ul style="list-style-type: none"> • No gyroscopic effect • Direct drive eliminates belt slippage
Reduced Excavation	<ul style="list-style-type: none"> • Allows cutting from one side, reducing excavation under pipe.
Better Access	<ul style="list-style-type: none"> • Easier to use in confined spaces • Precision cutting around neighboring utilities • Various bar lengths 38 cm/40 cm, 50 cm & 63 cm
Versatility	<ul style="list-style-type: none"> • Various chain types can meet job needs • Cuts most materials similar to a cut-off saw • Hydraulic saw is submersible



POWERGRIT® METHOD



CONVENTIONAL METHOD



No rotational kickback

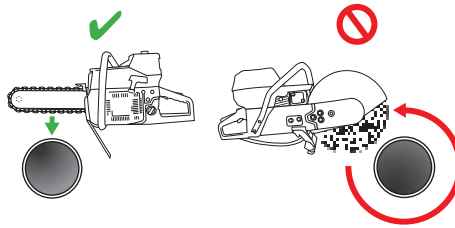

Single side access



Better operator control

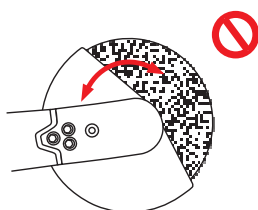

Safety not compromised



No flying debris



No dust

Effective January 1, 2013

ICS | Blount Europe S.A. • Rue Emile Francqui, 5 • 1435 Mont Saint-Guibert, Belgium • T +32 10 301 251 • F +32 10 301 259
© 2013 ICS | Blount Inc. PowerGrit® is a registered trademark and patent pending product of Blount Inc. 0213

POWERGRIT.COM

POWERGRIT® UTILITY SAW CHAIN

Water | Waste Water | Commercial Infrastructure

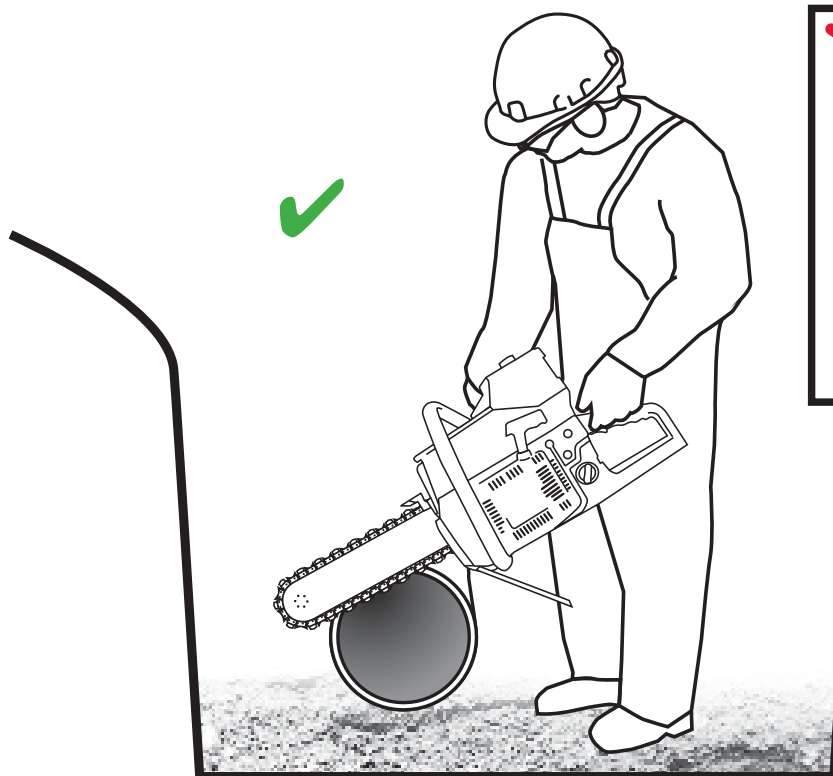

POWERGRIT® METHOD

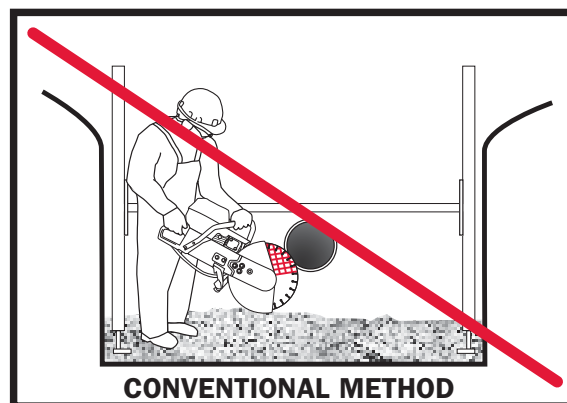

CONVENTIONAL METHOD

- INCREASED SAFETY
- IMPROVED OPERATOR CONTROL
- REDUCED EXCAVATION
- BETTER ACCESS
- VERSATILITY

ICS UTILITY SAW CHAIN

- Cutting depth of 38 cm/40 cm, 50 cm & 63 cm
- No rotational kickback
- Gyroscopic motion eliminated
- Chain stops quickly after throttle released
- Reduced excavation below the pipe
- Cutting depth allows for single side access
- Direct drive sprocket eliminates slippage

CONVENTIONAL METHOD

- Cutting depth of 10 cm - 12 cm
- Operator exposed to potential rotational kickback
- Gyroscopic motion reduces saw control
- Blade continues turning after throttle is released
- Excess excavation needed to cut below the pipe
- Access to both sides of pipe is required
- Blade slips when belts get wet

Observe all local and federal excavation regulations

Effective January 1, 2013

ICS | Blount Europe S.A. • Rue Emile Francqui, 5 • 1435 Mont Saint-Guibert, Belgium • T +32 10 301 251 • F +32 10 301 259
© 2013 ICS | Blount Inc. PowerGrit® is a registered trademark and patent pending product of Blount Inc. 0213

POWERGRIT.COM

TECHNOLOGY ADVANTAGES



Fire & Rescue | Underwater | Construction



Cuts Multiple Materials:

**Ductile Iron Pipe • Cast Iron Pipe • PVC Pipe
HDPE Pipe • Insituform Pipe Lining • Asbestos* Concrete Pipe**

Product Benefits:

**No rotational kickback • Single-point access • Better operator control
Safety not compromised • No flying debris • No dust**

* Asbestos is a hazardous material, known to cause serious respiratory diseases. Cutting into asbestos can release asbestos fibers into the air. Always research and follow the correct safety procedures, including applicable national and state or provisional occupational health and safety regulations, and protect yourself and those around you from asbestos-related disease. Always arrange for the material to be removed safely by a qualified person. ICS is not responsible for exposure to asbestos caused by use of this product.



PRICING SAWS, CHAINS, GUIDE BARS

ICS UTILITY CUTTING

695PG PETROL SAW



- > 94 cc, 2-Stroke engine
- > 4.8 kW
- > Under 10 kg

695PG UTILITY CHAIN SAW PACKAGES

P/N	DESCRIPTION
545018	695PG-16 Petrol Saw Package with 40 cm guidebar, PowerGrit-29 chain

695PG UTILITY CHAINS AND GUIDE BARS

P/N	DESCRIPTION
537764	PowerGrit-29/40 cm chain
524490	695F4 Guidebar 40 cm/29 segments



890PG HYDRAULIC SAW



- > Hydraulically powered
- > 30 lpm
- > Under 13 kg with bar and chain

880PG UTILITY CHAIN SAW PACKAGES

P/N	DESCRIPTION
566123	890PG-15 Hydraulic Saw Package with 38cm guidebar, PowerGrit-29 chain, 30 cm hose whips
566710	880PG-20 Hydraulic Saw Package with 50cm guidebar, PowerGrit-34 chain 2.5 m hose whips

880PG UTILITY CHAINS AND GUIDE BARS

P/N	DESCRIPTION
537764	PowerGrit-29/38 cm chain
523080	880F4 Guidebar 38 cm/29 segments
537765	PowerGrit-34/50 cm chain
529767	880F4 Guidebar 50 cm/34 segments
545017	PowerGrit-40/63 cm chain
525320	880F4 Guidebar 63 cm/40 segments

ICS CONCRETE CUTTING

695PG & 880PG saws are capable of operating ICS FORCE4® concrete chains

695PG CONCRETE CHAINS AND GUIDE BARS

P/N	DESCRIPTION
525342	ProFORCE-29/40 cm chain
524490	695F4 Guidebar 40 cm/29 segments

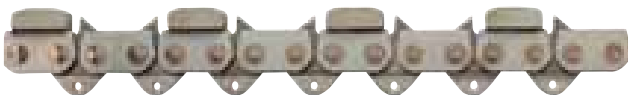

880PG CONCRETE CHAINS AND GUIDE BARS

P/N	DESCRIPTION
525342	ProFORCE-29/38 cm chain
523080	880F4 Guidebar 38 cm/29 segments
531749	ProFORCE-34/50 cm chain
529767	880F4 Guidebar 50 cm/34 segments
525345	ProFORCE-40/63 cm chain
525320	880F4 Guidebar 63 cm/40 segments

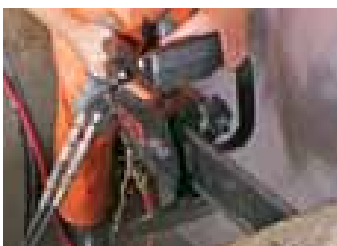

Effective January 1, 2013

ICS | Blount Europe S.A. • Rue Emile Francqui, 5 • 1435 Mont Saint-Guibert, Belgium • T +32 10 301 251 • F +32 10 301 259
© 2013 ICS | Blount Inc. PowerGrit® is a registered trademark and patent pending product of Blount Inc. 0213

POWERGRIT.COM

ACCESSORIES



PIPE CLAMP



The 880F4 pipe clamp brings a new level of safety, accuracy and ease of use to the job. Mount to this clamp and dramatically reduce the effort of handling the saw, while providing a solid, stable cutting platform that also improves operator safety and the precision of the cut.

P/N	DESCRIPTION
537640	PIPE CLAMP, POWERGRIT SYSTEM 880/853
537634	AXLE KIT, PIPE CLAMP 880/853

(FOR 880PG HYDRAULIC SAW ONLY)

WATER TANK

P/N	DESCRIPTION
551529EU	Portable Water Tank - EU

When water is not readily available, this fully portable, cordless, rechargeable water supply is the solution. Able to hold 35 litres of water, this supply system is equipped with a high-flow diaphragm pump that offers 4 litres per minute at 2.5 bar - enough flow and pressure to operate any ICS saw. The system comes equipped with an on-board charging system that will operate from a standard 240v/50Hz circuit and includes oversized inflatable tires and a quick-connect garden hose fitting.



POWER SUPPLY



Consider the convenience of portable hydraulic power with an ICS P95 Powerpack. Or connect to existing hydraulic systems such as backhoes and skidsteers with a flow adapter valve.



P/N	DESCRIPTION
550888	P95 13kW Multiflow hydraulic powerpack, adjustable 20 l/m or 30 l/m with auto throttle, electric start and hoses.
70350	Flow Adapter Valve 30 l/m
70466	7.5 m Hydraulic Hose Set, Two-way with couplers.

2-STROKE ENGINE OIL

P/N	DESCRIPTION
505880	2-Stroke Oil, 25:1 Mix, 200 ml Bottles (6-Pack)

Intensive laboratory and field testing have resulted in an oil formula that is cleaner burning, provides better thermal protection and an improved film barrier reducing piston ring wear. Protect your investment with work-proven ICS® 2-stroke Engine Oil.



Effective January 1, 2013

ICS | Blount Europe S.A. • Rue Emile Francqui, 5 • 1435 Mont Saint-Guibert, Belgium • T +32 10 301 251 • F +32 10 301 259
© 2013 ICS | Blount Inc. PowerGrit® is a registered trademark and patent pending product of Blount Inc. 0213

POWERGRIT.COM

FREQUENTLY ASKED QUESTIONS

Why consider an alternative to the current methods for cutting ductile iron pipe?

Safety, time and money. The most widely used method for cutting ductile iron pipe now is the petrol powered "cut-off saw" with a circular abrasive or diamond blade. Maneuvering a circular blade around the outside of a pipe to complete a cut requires a large area be excavated to accommodate the saw and operator. The need to cut all the way around the outside of the pipe may require use of the saw in a non-ergonomic position, which can be very difficult and unsafe.

How fast will a PowerGrit utility saw chain cut?

Depending on the saw and other factors, including pipe wall thickness, hardness, operator experience and others, a PowerGrit chain can cut through a 25 cm ductile iron pipe in as little as 3 to 5 minutes.

How long will a PowerGrit utility saw chain last?

PowerGrit chains can last as long as 20 to 40 cuts through 25 cm ductile iron pipe.

Note: The number of cuts will vary depending on many factors, including pipe diameter, pipe wall thickness and/or hardness, position of the pipe in the trench, factors related to the saw, operator experience and more. PowerGrit Chains being run on hydraulic powered saws may get as much as 30% more chain life than on petrol powered saws, depending on conditions. Cutting into materials surrounding the pipe can reduce chain life, as can inadequate water supply to the saw.

What kind of saw do I need to use PowerGrit utility saw chain?

PowerGrit utility saw chain cannot run on a traditional or regular chain saw. This is due to the amount of horsepower required, the requirement for water to be pumped through the bar, and the other components required to run PowerGrit chain including FORCE4® guidebars and sprockets. ICS offers two systems that meet these requirements; the 94 cc petrol powered 695F4/PG, and the hydraulically powered 880F4/PG.

What is the largest pipe diameter that can be cut?

When cutting free-hand without use of the pipe clamp, there is no limit to the diameter of pipe that can be cut. If the pipe diameter is larger than the cutting length of the bar, it must be cut from two sides. Pipe clamp is available for the 880PG hydraulic saw only.

Does the chain require water?

ICS recommends approximately 4 litres per minute of water at 1.4 bar of water pressure. This can be supplied by a common home or building faucet, an on-site water truck or mobile tank. A small tank with a DC electric motor attached can be purchased inexpensively for the back of a pickup or ATV.

Does the chain require water lubrication if there is already water in the pipe or trench?

Yes. The chain is lubricated and cooled with water through the guidebar which is the only way to ensure adequate surface cooling.

Is it okay to cut with the tip of the bar in the dirt?

Cutting with the tip of the bar in dirt will increase chain stretch, increase cut times and reduce chain life. Further, the operator should always try to avoid cutting in the dirt or beyond the visible cutting area due to the possibility of making contact with other buried utilities and obstructions.

When cutting pipe in the ground, will the bar and chain become pinched during cutting?

Before cutting, make sure the pipe is in a safe condition to be cut by ensuring support of the work piece in such a way that the cut remains open during the cutting operation and when the cut is finished.

Can I cut a pipe full of water under pressure?

Yes, PowerGrit offers the distinct advantage of being able to make a cut through a pipe full of water and under pressure. The chain technology maintains a high cut speed, whereas competitive methods require the pipe to drain and pressure be relieved before continuing with cut.



CONCRETE. STONE. MASONRY. PIPE.



PowerGrit.com • +32 10 301 251
Europe@powergrit.com